



ROFANA COMPOUND

Our Facilities Includes

Security and Surveillance
A Large Swimming Pool of 32 mtrs
Children's play area / Gymnasium
T.V. Studio with Dish Antennas
Landscape Garden
Telephone & Intercom
Telefax Services
Laundry Service
Shaded Car Parking Space



ROFANA-1

ROFANA-2

Rofana-1	Entitles	Total No of Apartments
3 Bed Room Apartments	3 Bed Rooms. 3 Bath Rooms. 1 Living Area. 1 kitchen.	12 (3 x4)
2 Bed Room Apartments	2 Bed Rooms. 2 Bath Rooms. 1 Living Area. 1 kitchen.	16 (4 x4)
Penthouse	4 Bed Rooms. 4 Bath Rooms. 2 Living Area. 1 kitchen.	02 (Terrace)
Extras	Drivers Room	06 (Ground Floor)

Rofana-2	Entitles	Total No of Apartments
3 Bed Room Apartments	3 Bed Rooms. 3 Bath Rooms. 1 Living Area. 1 kitchen. + Home made Room.	24 (6 x4)
2 Bed Room Apartments	2 Bed Rooms. 2 Bath Rooms. 1 Living Area. 1 kitchen.	06 (3/4 floor 2x2=4) (1/2 floor 1x2=2)
Studios	1 Bed Rooms. 1 Bath Rooms. 1 Living Area. 1 kitchen.	04 (1/2 floor 2x2=4)
Penthouse	4 Bed Rooms. 4 Bath Rooms. 2 Living Area. 1 kitchen. + Home made Room.	02 (Terrace)
Extras	Drivers Room	06 (Ground Floor)

- Rofana-1 having 4 floors.
- Penthouse is on Terrace.

- Rofana-2 having 4 floors.
- Penthouse is on Terrace.





ROFANA FACILITIES

- Security and surveillance are on alert 24 hours a day. Additional security measures includes 13 CCTV Cameras have been installed around the walls, and are monitored from multiple control centers to ensure your complete privacy and security.
- Ideal for Western Expatriates and Senior Executives
- A large Swimming Pool of 32 mtrs with attractive surrounding areas and children pool.
- Gymnasium.
- 24x7 Housekeeping Facilities.
- Barbicue in the Landscape Garden.
- Internet Facility to all the Apartments.
- Mail services.
- T.V. studio with dish antennas, video channel, connected by cable to each apartments.
- Landscape garden.
- Children's park & play area.
- 24 hours security services & maintenance.
- Telephone & Intercom.
- Telefax services.
- Shaded Car parking space.



PROPERTY PLAN OF ROFANA COMPOUND

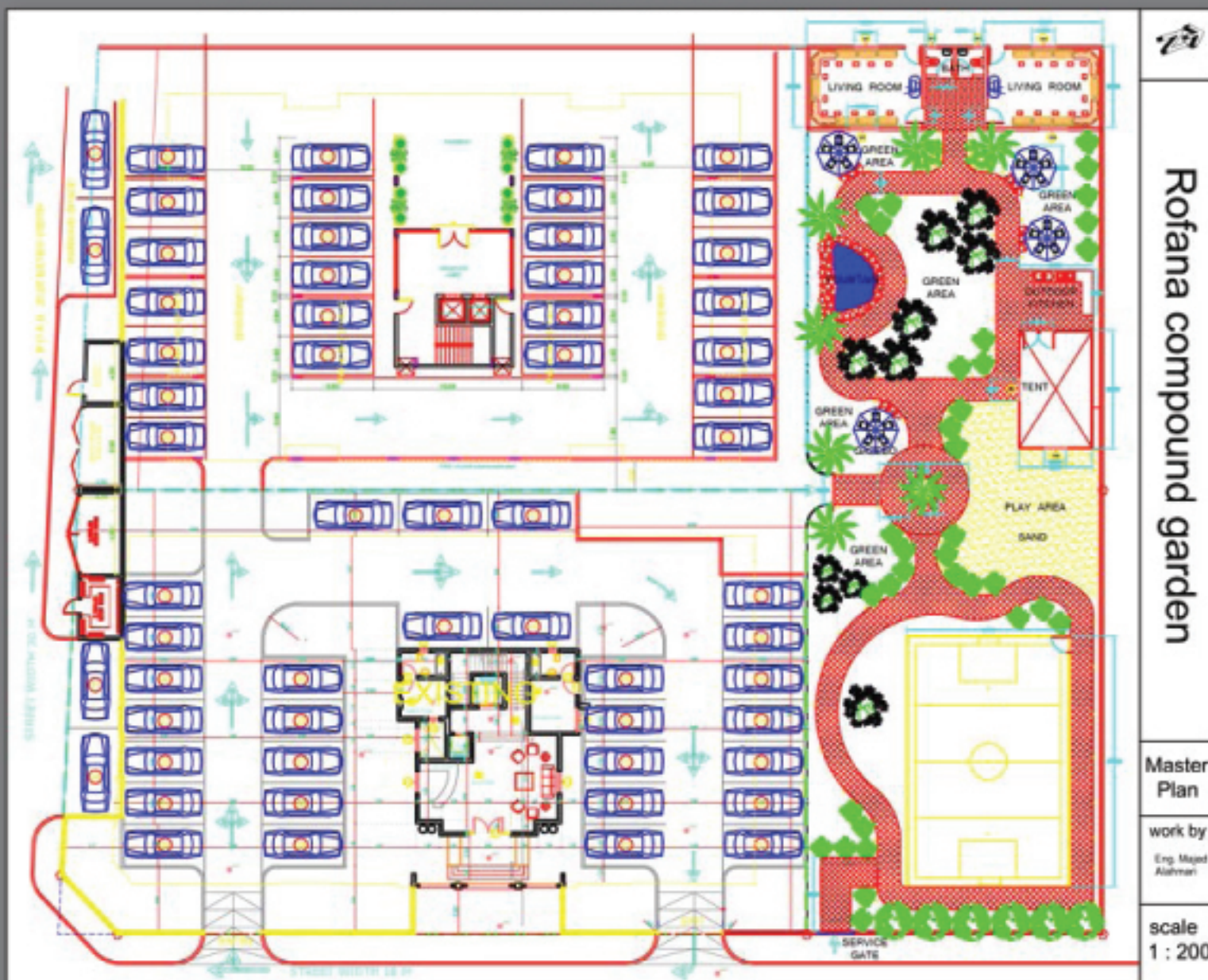

RAEED ALHMARI (General Manger)

Rofana Residential Compound
PO. BOX 5536, Dhahran 34451
Building NO: 7668, Gashla Road Althuraya.
Kingdom of Saudi Arabia

T : +966 13 859 3555 / 847-8877

F : +966 13 859 3555

E : info@rofana.com

W : www.rofana.com

ASAD-U-LLAH GAALIB(Admin Cordinator)

Rofana Residential Compound
PO. BOX 5536, Dhahran 34451
Building NO:7668, Gashla Road Althuraya.
Kingdom of Saudi Arabia

T : +966 13 859 3555 / 847-8877

F : +966 13 859 3555

M : +966 53 676 4098

E : asadullah@rofana.com



Add Rofana Compound to your contacts list
by scanning this code with your smartphone.



visit us @ website -www.rofana.com